



City of Chestermere
PROVINCE OF ALBERTA

Bylaw #029-25

Bylaw #029-25

Mural Land Use Bylaw Amendment

**A BYLAW OF THE CITY OF CHESTERMERE, IN THE PROVINCE OF ALBERTA, TO
AMEND THE LAND USE BYLAW #020-24, AS AMENDED.**

WHEREAS the *Municipal Government Act, RSA 2000, c. M-26* and amendments thereto provides that a Municipal Council must pass a Land Use Bylaw;

AND WHEREAS Council deems it desirable to amend Bylaw #020-24, being the Land Use Bylaw, as amended;

**NOW THEREFORE, THE COUNCIL OF THE CITY OF CHESTERMERE ENACTS AS
FOLLOWS:**

1. That Schedule "A" of Bylaw #020-24, being the Land Use Bylaw, as amended: Land Use Map is amended by redesignating a portion of N.E. ¼ SEC. 11 TWP. 24, RG. 28, W. 4th M. containing approximately 25.4 hectares (62.8 acres) from Large Lot Rural Residential District (LLR) to: Residential Single Detached District (R-1), Residential Planned Lot Rear-Lane District (R-1PRL), Residential Multi-Unit District (R-3), Low Rise Multi-Unit Residential District (R-4), Local Commercial District (C), and Public Service District (PS) as shown in Schedule "A" of this Bylaw.

2. SEVERABILITY

If any sections or parts of this Bylaw are found in any court of law to be illegal or beyond the power of Council to enact, such sections or parts shall be deemed to be severable and all other Sections or parts of this Bylaw shall be deemed to be separate and independent there from and to be enacted as such.

3. GENERAL

This Bylaw shall take effect on the day which it is finally passed.

READ A FIRST TIME: December 9, 2025

READ A SECOND TIME _____

READ A THIRD TIME _____

RESOLUTION NUMBERS:

251209-12

DRAFT

Mayor, Shannon Dean

Chief Administrative Officer, Kent Edney

SCHEDULE "A"

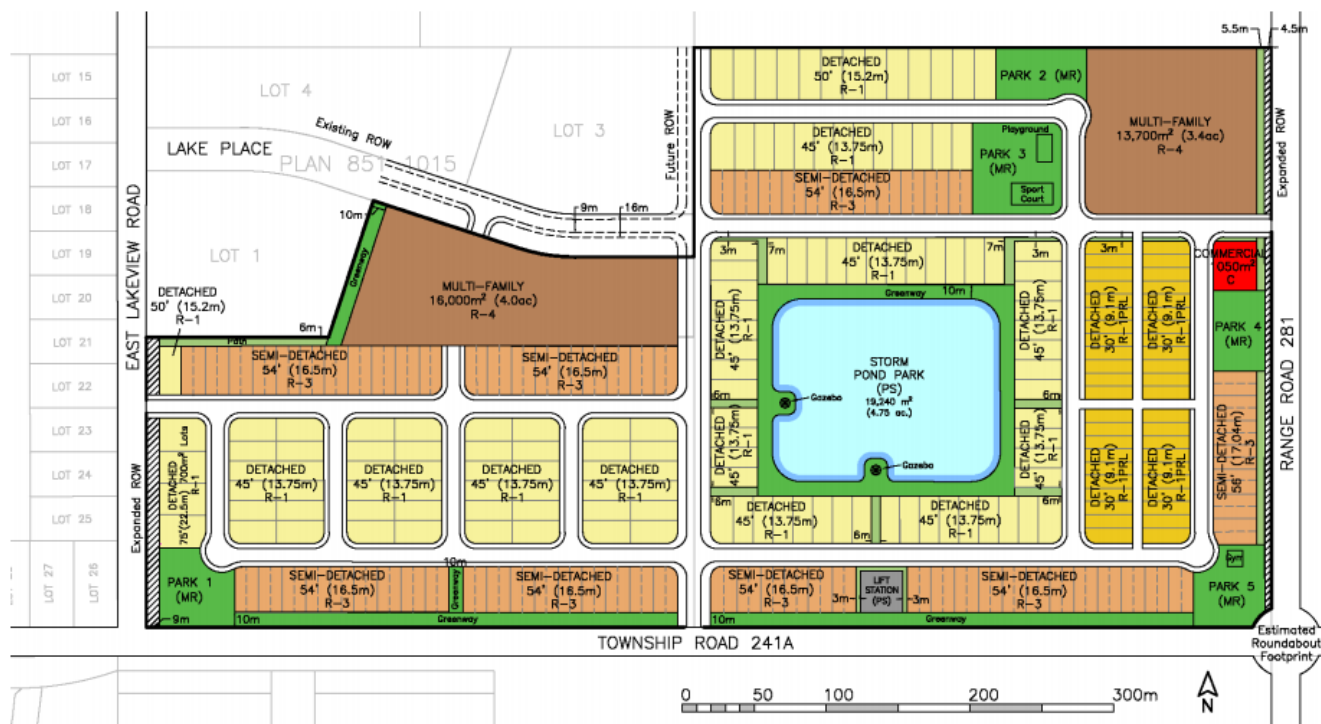

Legend

☐ Subject Bounds

 C: Local Commercial

 PS: Public Service (PUL)

 R-1: Detached Residential

 R-1PRL: Detached Rear Lane Dr.

 R-3: Residential Multi-Unit

 R-4: Low Rise Multi-Unit

 PS: Public Service (MR)

 PS: Public Service (Paths)

 Right-Of-Way Dedication